



## Flat 2 Elva Lodge Maidenhead

Price: £415,000 Leasehold

Flat 2 Elva Lodge,  
124 Grenfell Road  
Maidenhead, Berkshire SL6 1DW

Price £415,000 Leasehold

A fabulous and competitively priced ground floor apartment on this prestigious modern development a short walk from the town and station. The property is beautifully presented throughout with two double bedrooms, 2 bathrooms, lovely open plan living area with a bay window and balcony. There are communal gardens and secure gated parking. No onward chain.

**Council Tax band: D**      **EPC rating: B**

The M4 and M40 motorway are easily accessible providing access to Heathrow and Central London. Rail services to London Paddington are available from Maidenhead Station with an excellent service to London Paddington and directly into the city centre via the Elizabeth Line.

‘A

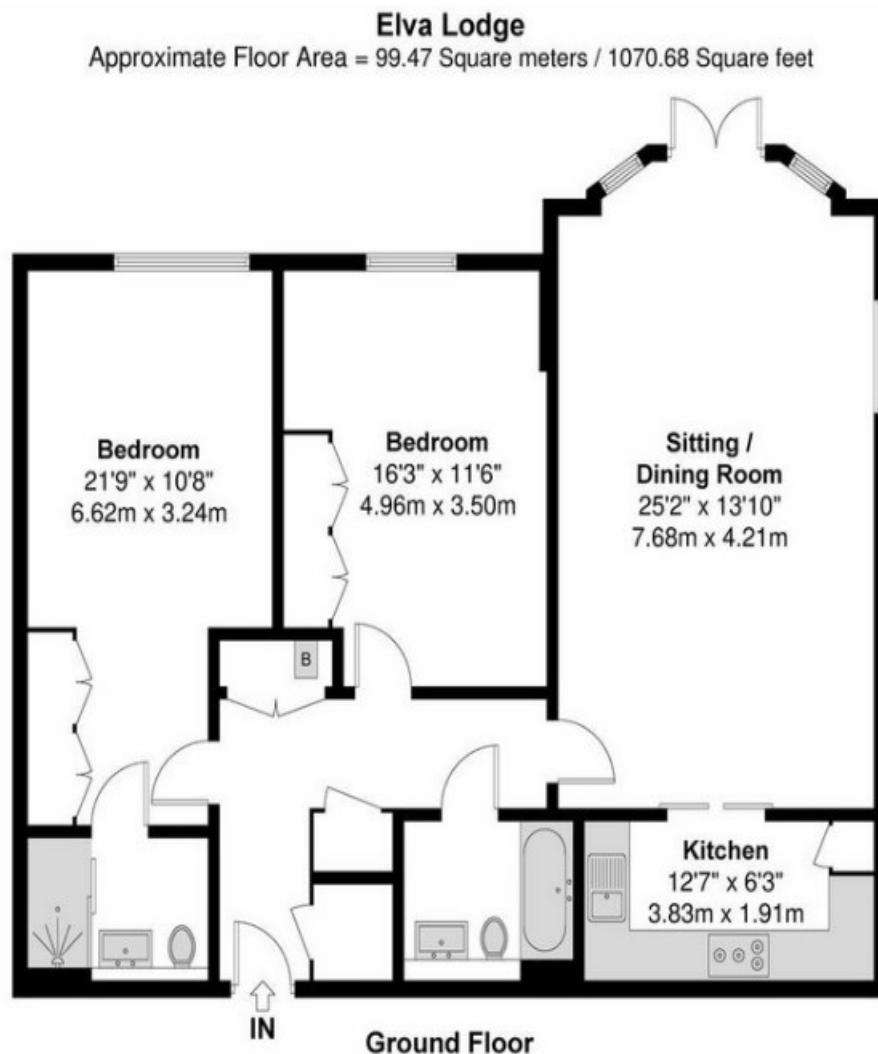

Illustration for identification purposes only,  
measurements are approximate, not to scale.









Directions: Proceed West on the A4/Castle Hill and at the brow of the hill turn left into Grenfell Road where the property is immediately on the left



**PIKE SMITH & KEMP**

22 QUEEN STREET, MAIDENHEAD, BERKSHIRE SL6 1HZ

MAIDENHEAD@PIKESMITHKEMP.CO.UK

[www.pskweb.co.uk](http://www.pskweb.co.uk)

01628 621177